

C SERIES BALL JOINTS

- Sizes 1" (DN25) - 8" (DN200)
- Higher sizes upon request
- Materials: ST52-3, 42CrMo4, AISI304/316/316TI
- Special materials upon request
- Manufactured in 4 styles
- Articulated motion only
- Angular movement $\pm 15^\circ$
- Faster and easier piping installation
- No lubrication required

Seals: - Teflon Seal
 - Glass Filled Teflon Seal

Special Option:
 - Injectable Flaked Graphite Sealant

Max. Temperature: $(-20^\circ\text{C}) - (120^\circ\text{C})$
 $(-4^\circ\text{F}) - (+250^\circ\text{F})$

Max. Pressure: 20 bar (290 psi)

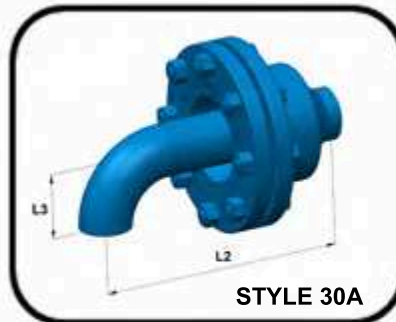

C SERIES BALL JOINT WELD END CONNECTIONS

ANGULAR MOVEMENT

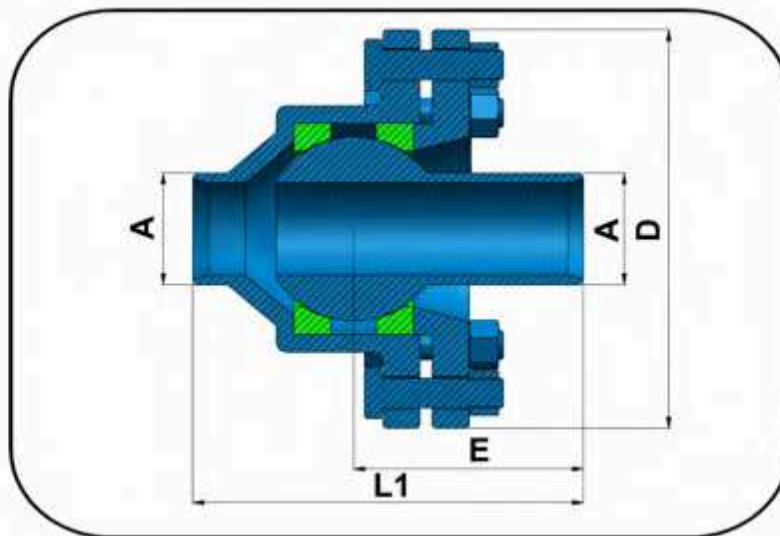
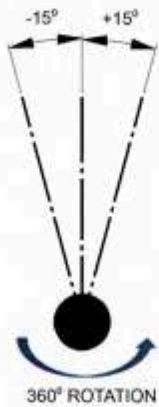

DIMENSIONS AND WEIGHTS

SIZE	D	E	L1	L2	L3	L4	WEIGHT (kg)			
							STYLE 20	STYLE 30/30A	STYLE 40	
1"	DN25	147	84	150	188	38	226	6,25	6,4	6,5
1 1/4"	DN32	176	104	186	234	48	282	10	10,2	10,5
1 1/2"	DN40	198	115	203	260	57	317	14	14,5	14,75
2"	DN50	215	124	221	297	76	373	17	17,5	18
2 1/2"	DN65	234	136	234	329	95	472	19	20	20,75
3"	DN80	270	133	242	356	114	470	28	29,5	30,5
4"	DN100	290	144	264	416	152	568	32	34,5	37
5"	DN125	326	155	279,5	469,5	190	659,5	43	47	51
6"	DN150	349	164	292	521	229	750	53	59,5	66
8"	DN200	399	173	307	612	305	917	68	83	98

Please consult factory for sizes above 8" (DN200)